

HOTPOT

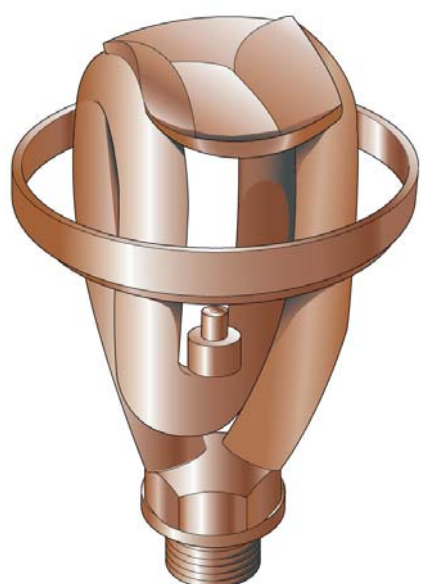

Pressure Stove Product Code KP005

Replacement Parts

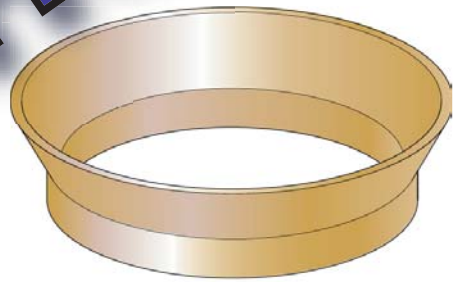

Product Code KP0505

- This Burner head was fitted to a Stove which won a substantial cash prize in a competition for efficient Stoves.
- This Burner Head will fit almost all Pressure Stoves already on the market.
- It is good value for money.
- This Burner Head rapidly converts paraffin into vapour.
- It emits a brilliant blue flame without emitting carbon as in the case of many other Burners.
- There are limited numbers of brazing joints in the hottest region at the top of the Burner.
- This Burner Head consumes 175 gm/hr of paraffin at 1 kg/cm² against 285 gm/hr on normal Burners.
- The saving on the paraffin is in excess of 30% of normal Burners.
- The Lead pipe uniformly discharges the paraffin vapour.
- The Burner Head is easily maintained. Replacement parts and tools are provided with each Stove.
- The Burner has a single venturi (nipple) which causes less accumulation of carbon than normal Burner Heads which have 4 venturies.
- The special Brass Flame Spreader (product code KP0570) suspended over the Burner Head guides the flame to form a vertical column of flame which improves the spreading of the flame under the cooking vessel.
- There are no brazing joints at the top of the Burner Head where the Temperature mounts to 300 - 400 degrees C making it safe as it is explosion free.

For the Technically minded Technical Data for Lotus Patented Roarer Burner Head

DATA	Units	Venus burner with metal flame ring	Conventional burner with metal flame ring
O ₂	%	18.6	18.6
CO	ppm	4530	2352
CO ₂	%	1.70	2.00
NO ₂	ppm	8	6
SO ₂	ppm	80	17
Gas Temperature	° C	116	143
Amb. Temperature	° C	28.7	29.7
Avg. Velocity	m/s	2.35	2.87
Avg. Flue Gas flow (calculated)	M ³ /hr	4.16	5.08
Avg. Fuel consumption for raising water temperature of known qty. from 40° C to 90° C	gm/hr	51.13	67.125

Note:
Keosene oil pressure is maintained at 1.4 hg/cm
Diameter of flow for flue gas as measured: 25mm
Effective cross sectional area of flue gas duct: 491.7mm